



# TSP-1PAG30305MZ

TSP

TEMPERATURE SENSORS

**SICK**  
Sensor Intelligence.



Illustration may differ

### Ordering information

Type	Part no.
TSP-1PAG30305MZ	6042942

Other models and accessories → [www.sick.com/TSP](http://www.sick.com/TSP)

### Detailed technical data

#### Features

<b>Measuring range</b>	-30 °C +130 °C
<b>Output signal</b>	Pt100, 2-wire

#### Mechanics/electronics

<b>Process connection</b>	Thread G 3/8 B
<b>Insertion length/diameter of probe</b>	30 mm / 5 mm
<b>Wetted parts</b>	Stainless steel 1,4305
<b>Housing material</b>	Stainless steel 1,4305
<b>Measuring current</b>	0.3 mA ... 1 mA
<b>Electrical safety</b>	Protection class: III, dielectric strength: 500 V AC
<b>RoHS certificate</b>	✓
<b>Weight</b>	Approx. 30 g (depending on configuration)

#### Performance

<b>Accuracy of sensor element</b>	Class B according to IEC 60751
<b>Response time</b>	Response time $t_{50}$ : ≤ 2.5 s <sup>1)</sup> Response time $t_{90}$ : ≤ 6 s <sup>1)</sup>

<sup>1)</sup> Depending on sensor configuration, according to IEC 60751.

#### Ambient data

<b>Ambient temperature</b>	-40 °C ... +100 °C <sup>1)</sup>
<b>Storage and transport temperature</b>	-40 °C ... +85 °C
<b>Shock resistance according to IEC 60751</b>	500 g
<b>Vibration resistance according to IEC 60751</b>	3 g

<sup>1)</sup> Due to the short length, the temperature at the male connector may rise to impermissibly high values. This MUST be taken into account when configuring the measuring point and selecting a suitable connecting cable.

#### Classifications

<b>ECl@ss 5.0</b>	27200208
<b>ECl@ss 5.1.4</b>	27200208
<b>ECl@ss 6.0</b>	27200208

<b>ECI@ss 6.2</b>	27200208
<b>ECI@ss 7.0</b>	27200208
<b>ECI@ss 8.0</b>	27200208
<b>ECI@ss 8.1</b>	27200208
<b>ECI@ss 9.0</b>	27200208
<b>ECI@ss 10.0</b>	27200208
<b>ECI@ss 11.0</b>	27200208
<b>ETIM 5.0</b>	EC002994
<b>ETIM 6.0</b>	EC002994
<b>ETIM 7.0</b>	EC002994
<b>ETIM 8.0</b>	EC002994
<b>UNSPSC 16.0901</b>	41112211

**Dimensional drawing** (Dimensions in mm (inch))

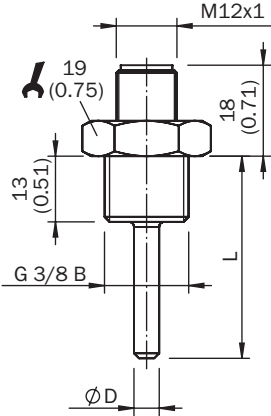

**Connection type**

Plug M12 x 1, output signal Pt100/Pt1000

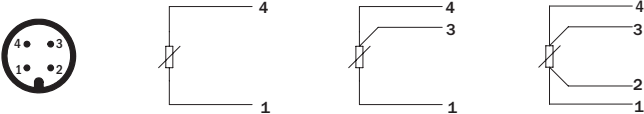

## SICK AT A GLANCE

SICK is one of the leading manufacturers of intelligent sensors and sensor solutions for industrial applications. A unique range of products and services creates the perfect basis for controlling processes securely and efficiently, protecting individuals from accidents and preventing damage to the environment.

We have extensive experience in a wide range of industries and understand their processes and requirements. With intelligent sensors, we can deliver exactly what our customers need. In application centers in Europe, Asia and North America, system solutions are tested and optimized in accordance with customer specifications. All this makes us a reliable supplier and development partner.

Comprehensive services complete our offering: SICK LifeTime Services provide support throughout the machine life cycle and ensure safety and productivity.

For us, that is “Sensor Intelligence.”

## WORLDWIDE PRESENCE:

Contacts and other locations –[www.sick.com](http://www.sick.com)